

Toughmate[®] Always-On G1 Nylon User Guide

For the Panasonic Toughpad G1



Introduction

Thank you for purchasing a Toughmate[®] Always-On series case from InfoCase[®]. Your case will provide added full-time protection and increased productivity while using your Toughpad G1.

Key Features

- Shock absorbing case materials provide 24x7 rugged protection.
- Ergonomic hand strap allows you to comfortably hold your G1 for extended periods of time.
- Easel functionality elevates screen for viewing and typing.
- Screen cover protects the display when not in use.

Features

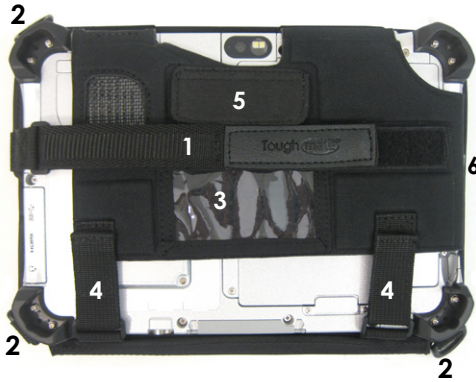

- 1) Hand Strap
- 2) Shoulder Strap Rings
- 3) ID Holder
- 4) Velcro Attachment Tabs
- 5) Easel Stand
- 6) Stylus Pen Loop

Your Toughmate case can be used with all variations of Toughpad G1 computers. Not for use with OEM hand strap.

Installing Your Toughpad G1

1

After loosening the Hand Strap (#1) and the Velcro Attachment Tabs (#4), slide your Toughpad G1 into the case at an angle.

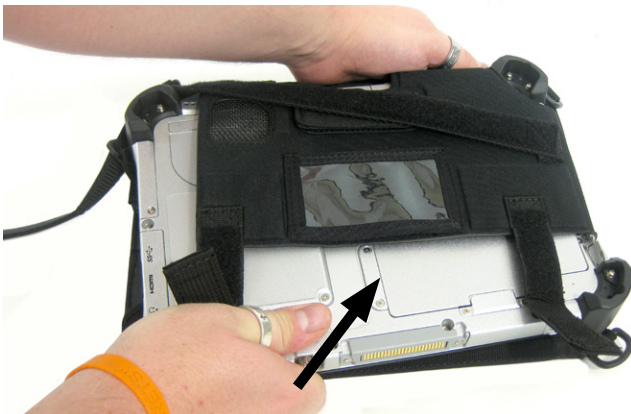

2

Once the tablet is pushed securely into the back corner of the case, put the Velcro Attachment Tabs and the Hand Strap through the appropriate d-rings.

Installing Your G1

3

While gently but firmly holding the G1 in place, pull the Velcro Attachment Tabs (#4) until the back of the case is tight against the G1. Then press the tabs down to secure the Velcro.

To remove your G1, simply release the Velcro, loosen the tabs and hand strap, and carefully remove the computer.



Converting Your Toughmate Case to Easel Mode

Your Toughmate case can be used as an easel for both typing and viewing. To put your case in either position, fold the screen cover behind the case and insert the front edge into the easel stand (#5) as shown below.



Typing Position



Viewing Position

Shoulder Strap

Your Toughmate case can be carried in a portrait or landscape orientation using the included shoulder strap. Simply clip the strap to two adjacent shoulder strap rings (#2).



Portrait orientation



Landscape orientation

Tips for use

1. The hand strap (#1) allows you to keep a firm grip on your Toughmate case during mobile use. It is not recommended to use the strap as a carry handle.
2. Your Toughmate case has openings for the most important buttons and ports. Care should be taken to protect the openings from rain or other liquids to avoid damage to your Toughpad G1.
3. When carrying your Toughmate case in landscape orientation using a shoulder strap, always use the d-rings on the same side as the Velcro Attachment Tabs (#4) to avoid inadvertent screen cover openings.

Warranty

InfoCase products are dynamic, consistently improved and reinvented to bring you the best products on the market. We use only the highest quality materials to meet your mobile technology demands.

InfoCase offers a limited lifetime warranty on defects and workmanship on your Toughmate case. This warranty does not cover normal wear and tear and/or damage caused by misuse or accident.

Please visit: <http://www.InfoCase.com/warranty.php> or call 1-800-248-4844 to obtain more information on the InfoCase warranty.